

## JANAPRIYA TOWNSHIPS PRIVATE LIMITED

Corporate Office:  
H NO 8/2/120/86 D NO 8-2-120/86/1,  
KEERTHI PRIDE TOWERS, ROAD NO 2,  
Banjara Hills  
Hyderabad - 500034  
P01100003966



**Client Name:**

9154150806

**Sales Executive:**

Prabhakar T

**Date:**

03 November 2023

## Unit Details

Unit Number	61004
Tower Name	Block-6
Project Name	Nilevalley
Saleable Area in Sq. Ft	1570.00
Saleable Area in Sq. Mts	145.86

## 2D Floor Plan

FLOOR PLAN - 3BHK , TYPE -4 Saleable Area 1570 Sq.ft



# Quote Block-6-61004

## Pricing Details

Description	Price ₹	GST %	GST Value ₹	Value ₹
<b>Basic Cost of Apartment</b>	1,00,48,000	5%	5,02,400	1,05,50,400
<b>Premium Charges Costs</b>				
Floor rise	2,35,500	5%	11,775	2,47,275
<b>Subtotal</b>	<b>2,35,500.00</b>		<b>11,775.00</b>	<b>2,47,275.00</b>
<b>Amenities</b>				
UTILITIES	3,30,000.00	5%	16,500.00	3,46,500.00
Club House	1,50,000.00	5%	7,500.00	1,57,500.00
Car Parking	2,00,000.00	5%	10,000.00	2,10,000.00
<b>Subtotal</b>	<b>6,80,000.00</b>		<b>34,000.00</b>	<b>7,14,000.00</b>
<b>Other Costs</b>				
LEGAL & DOCUMENTATION CHARGES				20,000.00
Maintenance Charges				84,425.00
<b>Subtotal</b>				<b>1,04,425.00</b>
<b>Total Cost</b>	<b>1,09,63,500.00</b>		<b>5,48,175.00</b>	<b>1,16,11,675.00</b>

## 3D Floor Plan

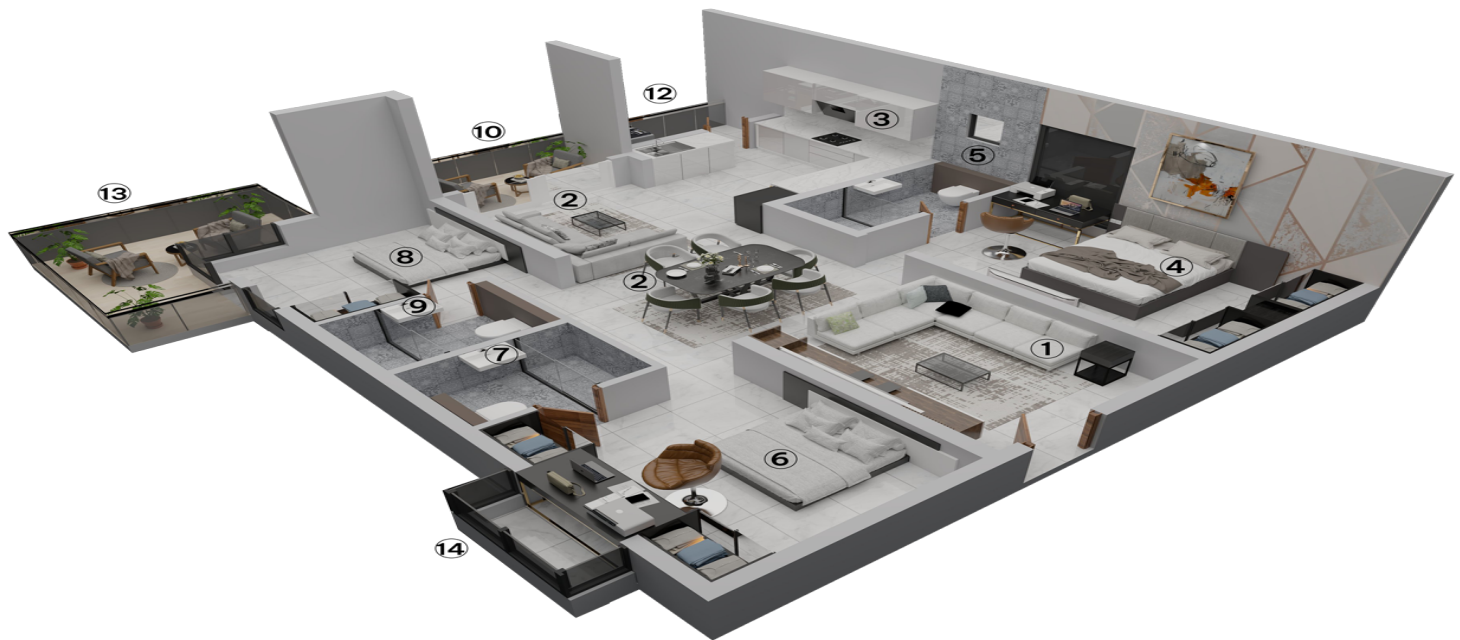

# Quote Block-6-61004

## Payment Schedule

SNo	Payment Schedule	% of Total Cost	Value ₹
1	Cost of land and land development	20%	23,23,220
2	Commencement of footings, foundations	20%	23,23,220
3	On Completion of Ground Floor Slab	5%	5,80,805
4	On Completion of 1st Floor Slab	5%	5,80,805
5	On Completion of 2nd Floor Slab	5%	5,80,805
6	On Completion of 3rd Floor Slab	5%	5,80,805
7	On Completion of 4th Floor Slab	5%	5,80,805
8	On Completion of 5th Floor Slab	5%	5,80,805
9	On Completion of 6th Floor Slab	5%	5,80,805
10	On Completion Of 7th Floor Slab	5%	5,80,805
11	On Completion Of 8th Floor Slab	5%	5,80,805
12	On Completion Of 9Th Floor Slab	5%	5,80,805
13	On Completion Of Flooring In Concerned Flat	5%	5,80,805
14	At Finishing	5%	5,80,805

### Note

- 1. Floor Rise & Premium charges are applicable accordingly*
- 2. Registration and stamp duty to be borne by purchaser as applicable at the time of registration*
- 3. 0.1% of e stamping charges to be borne by purchaser during agreement signing*
- 4. Premium charge of Rs. 50 will be applicable for units with barbeque terrace on 2nd, 5th and 8th floor*
- 5. This Quotation valid until 8/11/2023*