

# Quote Block-6-61001

## JANAPRIYA TOWNSHIPS PRIVATE LIMITED

Corporate Office:  
H NO 8/2/120/86 D NO 8-2-120/86/1,  
KEERTHI PRIDE TOWERS, ROAD NO 2,  
Banjara Hills  
Hyderabad - 500034  
P01100003966



**Client Name:**

Prashant

**Sales Executive:**

Sandeep Anaganti

**Date:**

05 January 2024

### Unit Details

Unit Number	61001
Tower Name	Block-6
Project Name	Nilevalley
Saleable Area in Sq. Ft	1520.00
Saleable Area in Sq. Mts	141.21

### 2D Floor Plan

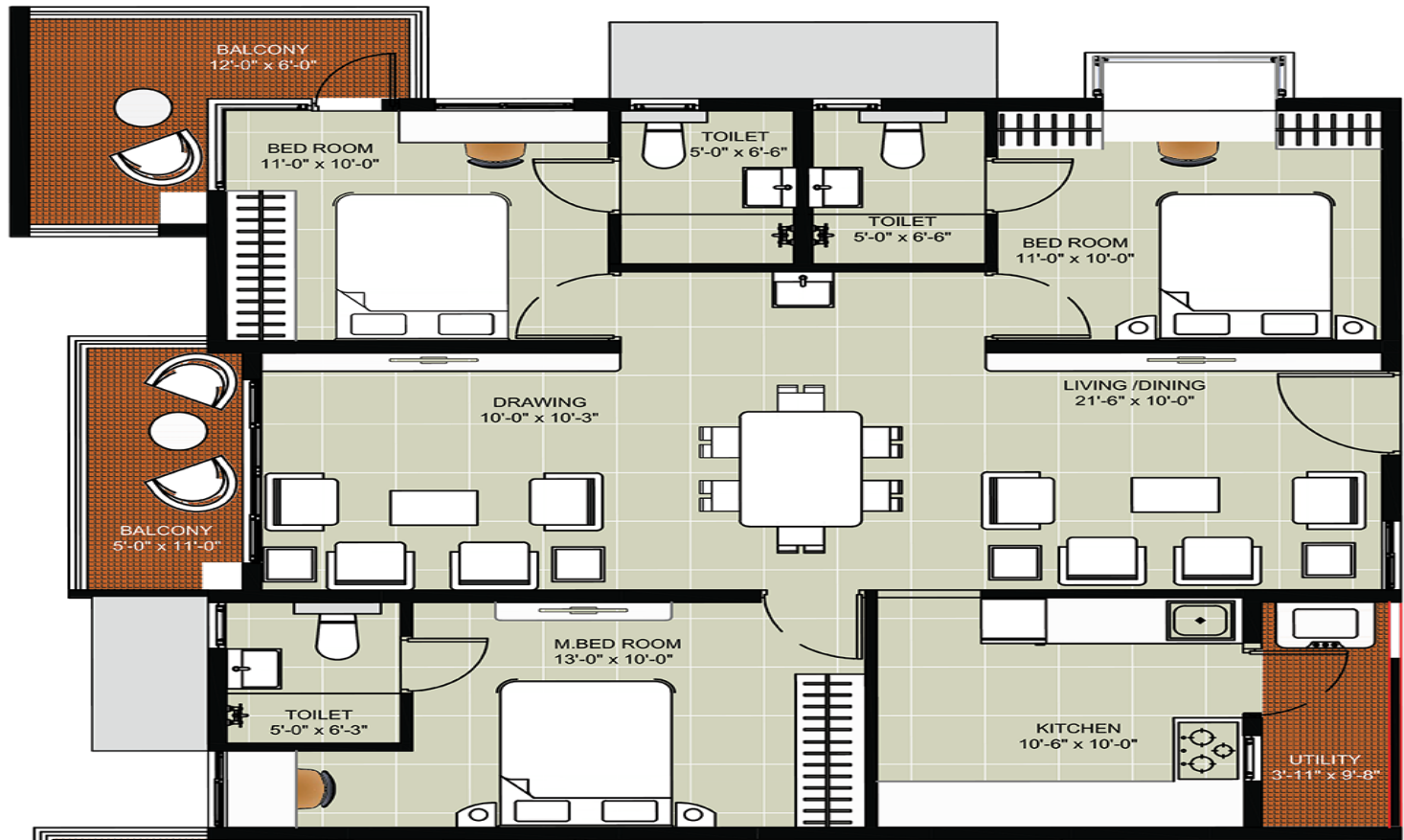

# Quote Block-6-61001

## Pricing Details

Description	Price ₹	GST %	GST Value ₹	Value ₹
<b>Basic Cost of Apartment</b>	97,28,000.00	5%	4,86,400.00	1,02,14,400.00
<b>Premium Charges Costs</b>				
Floor rise	2,28,000.00	5%	11,400.00	2,39,400.00
Face Charge	1,52,000.00	5%	7,600.00	1,59,600.00
<b>Subtotal</b>	<b>3,80,000.00</b>		<b>19,000.00</b>	<b>3,99,000.00</b>
<b>Amenities</b>				
UTILITIES	3,30,000.00	5%	16,500.00	3,46,500.00
Club House	1,50,000.00	5%	7,500.00	1,57,500.00
Car Parking	2,00,000.00	5%	10,000.00	2,10,000.00
<b>Subtotal</b>	<b>6,80,000.00</b>		<b>34,000.00</b>	<b>7,14,000.00</b>
<b>Other Costs</b>				
LEGAL & DOCUMENTATION CHARGES				20,000.00
Maintenance Charges				81,125.00
<b>Subtotal</b>				<b>1,01,125.00</b>
<b>Total Cost</b>	<b>1,07,88,000.00</b>		<b>5,39,400.00</b>	<b>1,14,28,525.00</b>

## 3D Floor Plan



# Quote Block-6-61001

## Payment Schedule

SNo	Payment Schedule	% of Total Cost	Value ₹
1	Cost of land and land development	20%	22,85,705.00
2	Commencement of footings, foundations	20%	22,85,705.00
3	On Completion of Ground Floor Slab	5%	5,71,426.25
4	On Completion of 1st Floor Slab	5%	5,71,426.25
5	On Completion of 2nd Floor Slab	5%	5,71,426.25
6	On Completion of 3rd Floor Slab	5%	5,71,426.25
7	On Completion of 4th Floor Slab	5%	5,71,426.25
8	On Completion of 5th Floor Slab	5%	5,71,426.25
9	On Completion of 6th Floor Slab	5%	5,71,426.25
10	On Completion Of 7th Floor Slab	5%	5,71,426.25
11	On Completion Of 8th Floor Slab	5%	5,71,426.25
12	On Completion Of 9Th Floor Slab	5%	5,71,426.25
13	On Completion Of Flooring In Concerned Flat	5%	5,71,426.25
14	At Finishing	5%	5,71,426.25

### Note

- 1. Floor Rise & Premium charges are applicable accordingly*
- 2. Registration and stamp duty to be borne by purchaser as applicable at the time of registration*
- 3. 0.1% of e stamping charges to be borne by purchaser during agreement signing*
- 4. Premium charge of Rs. 50 will be applicable for units with barbeque terrace on 2nd, 5th and 8th floor*
- 5. This Quotation valid until 10/1/2024*