

# Quote -61101

Corporate Office:  
-

**Client Name:**

vidaya hording

**Sales Executive:**

Sandeep Anaganti

**Date:**

28 December 2024

## Unit Details

Unit Number	61101
Tower Name	
Project Name	Nilevalley
Saleable Area in Sq. Ft	1520.00
Saleable Area in Sq. Mts	141.21

## 2D Floor Plan

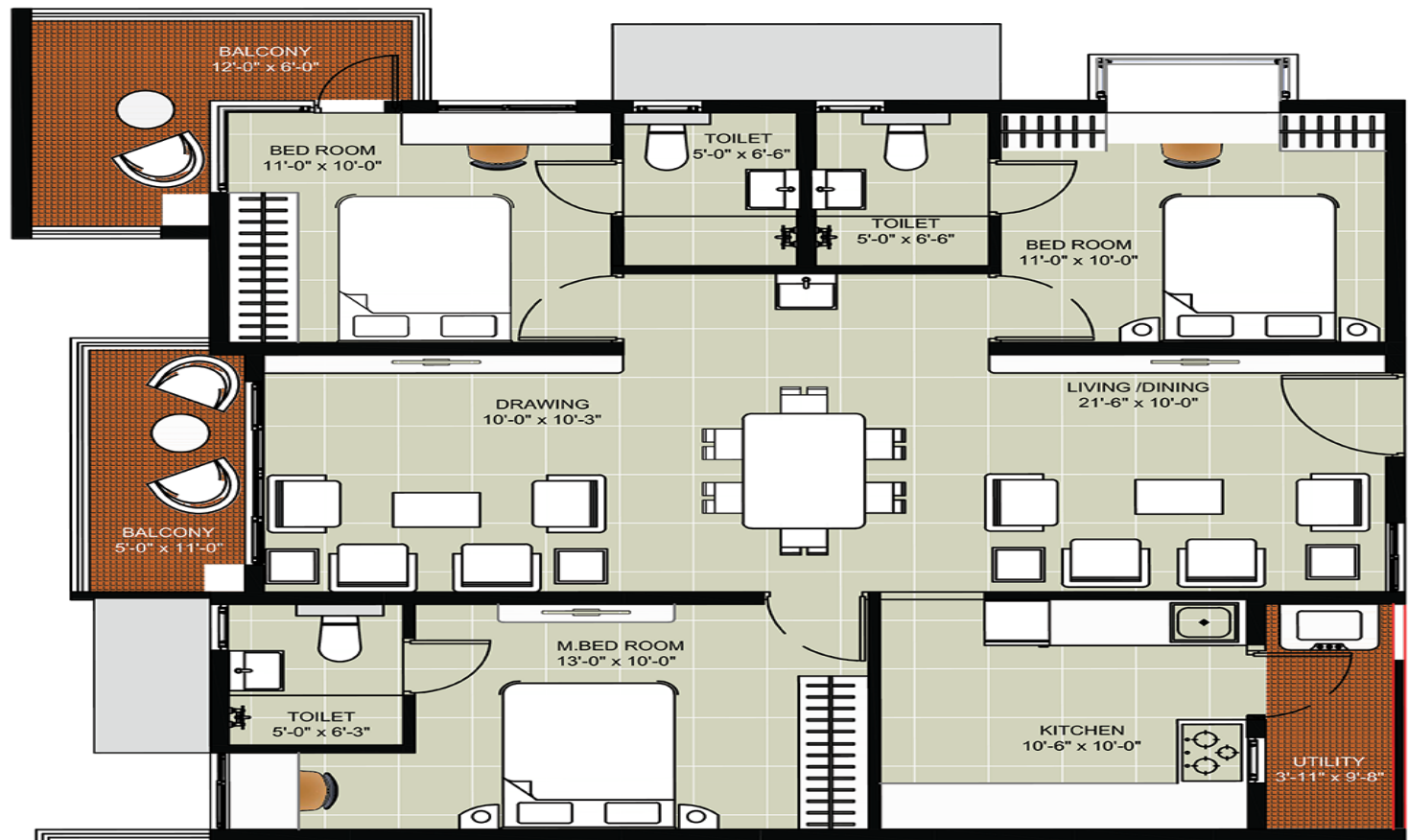

## Pricing Details

Description	Price ₹	GST %	GST Value ₹	Value ₹
<b>Basic Cost of Apartment</b>	1,00,32,000	5%	5,01,600	1,05,33,600
<b>Premium Charges Costs</b>				
Floor rise	2,28,000	5%	11,400	2,39,400
Face Charge	1,52,000	5%	7,600	1,59,600
Position Charge	1,52,000	5%	7,600	1,59,600
<b>Subtotal</b>	<b>5,32,000.00</b>		<b>26,600.00</b>	<b>5,58,600.00</b>
<b>Amenities</b>				
UTILITIES	3,30,000.00	5%	16,500.00	3,46,500.00
Club House	1,50,000.00	5%	7,500.00	1,57,500.00
Car Parking	2,00,000.00	5%	10,000.00	2,10,000.00
<b>Subtotal</b>	<b>6,80,000.00</b>		<b>34,000.00</b>	<b>7,14,000.00</b>
<b>Other Costs</b>				
LEGAL & DOCUMENTATION CHARGES				20,000.00
Maintenance Charges				83,600.00
<b>Subtotal</b>				<b>1,03,600.00</b>
<b>Total Cost</b>	<b>1,12,44,000.00</b>		<b>5,62,200.00</b>	<b>1,19,09,800.00</b>

## 3D Floor Plan



## Payment Schedule

SNo	Payment Schedule	% of Total Cost	Value ₹
1	Cost of land and land development	20%	23,81,960
2	On Commencement of footings, foundations	20%	23,81,960
3	On Commencement of Ground Floor Slab	5%	5,95,490
4	On Commencement of 1st Floor Slab	5%	5,95,490
5	On Commencement of 2nd Floor Slab	4%	4,76,392
6	On Commencement of 3rd Floor Slab	4%	4,76,392
7	On Commencement of 4th Floor Slab	4%	4,76,392
8	On Commencement of 5th Floor Slab	4%	4,76,392
9	On Commencement of 6th Floor Slab	4%	4,76,392
10	On Commencement of 7th Floor Slab	4%	4,76,392
11	On Commencement of 8th Floor Slab	4%	4,76,392
12	On Commencement Of 9th Floor Slab	4%	4,76,392
13	On Commencement Of 10th Floor Slab	4%	4,76,392
14	On Commencement Of 11th Floor Slab	4%	4,76,392
15	On Commencement Of Flooring In Concerned Flat	5%	5,95,490
16	At Finishing	5%	5,95,490

### Note

- 1. Floor Rise & Premium charges are applicable accordingly*
- 2. Registration and stamp duty to be borne by purchaser as applicable at the time of registration*
- 3. 0.1% of e stamping charges to be borne by purchaser during agreement signing*
- 4. Premium charge of Rs. 50 will be applicable for units with barbeque terrace on 2nd, 5th and 8th floor*
- 5. This Quotation valid until 2/1/2025*